

Rhino & Prowler front seat Installation Instructions

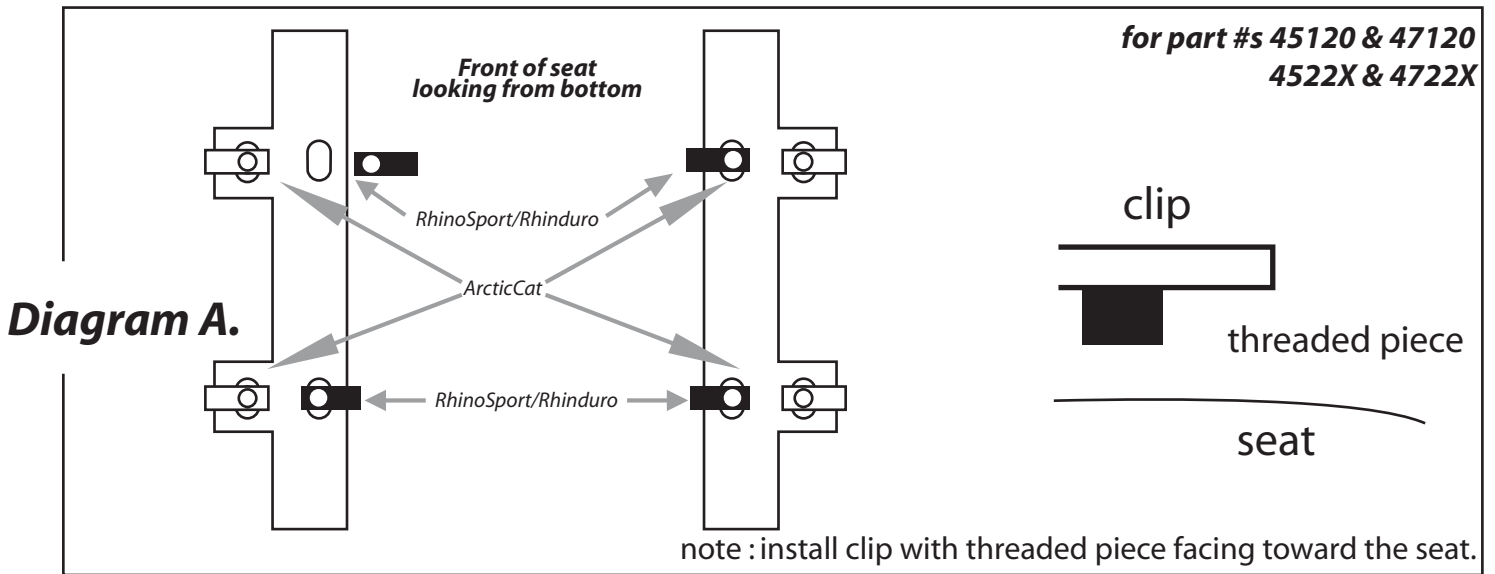

Driver ——— Front ——— Passenger

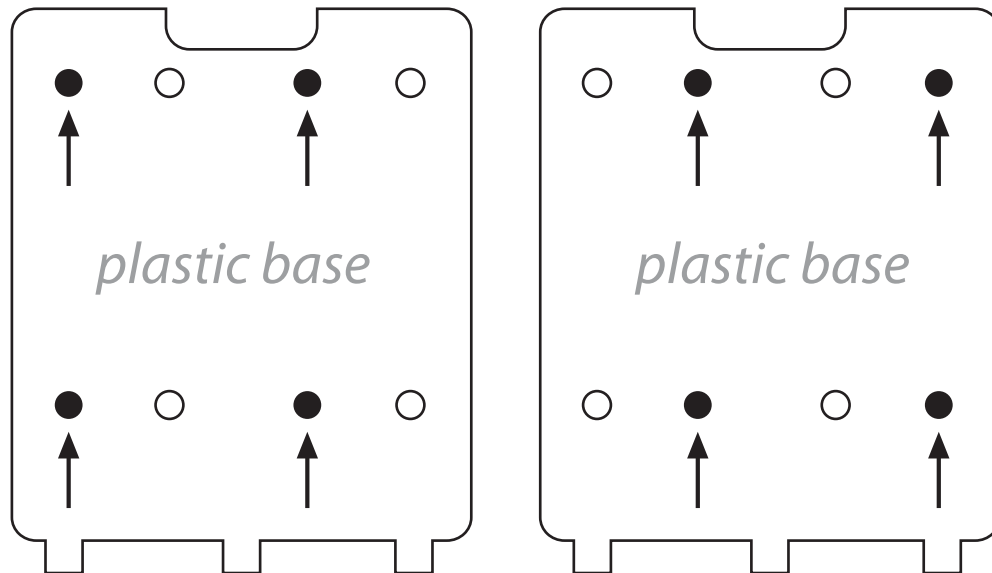

Bolt Pattern Install - looking from bottom

Diagram B.

NOTE: N/A for ArcticCat Prowler

Rhino & Prowler OEM Seat Cover Installation

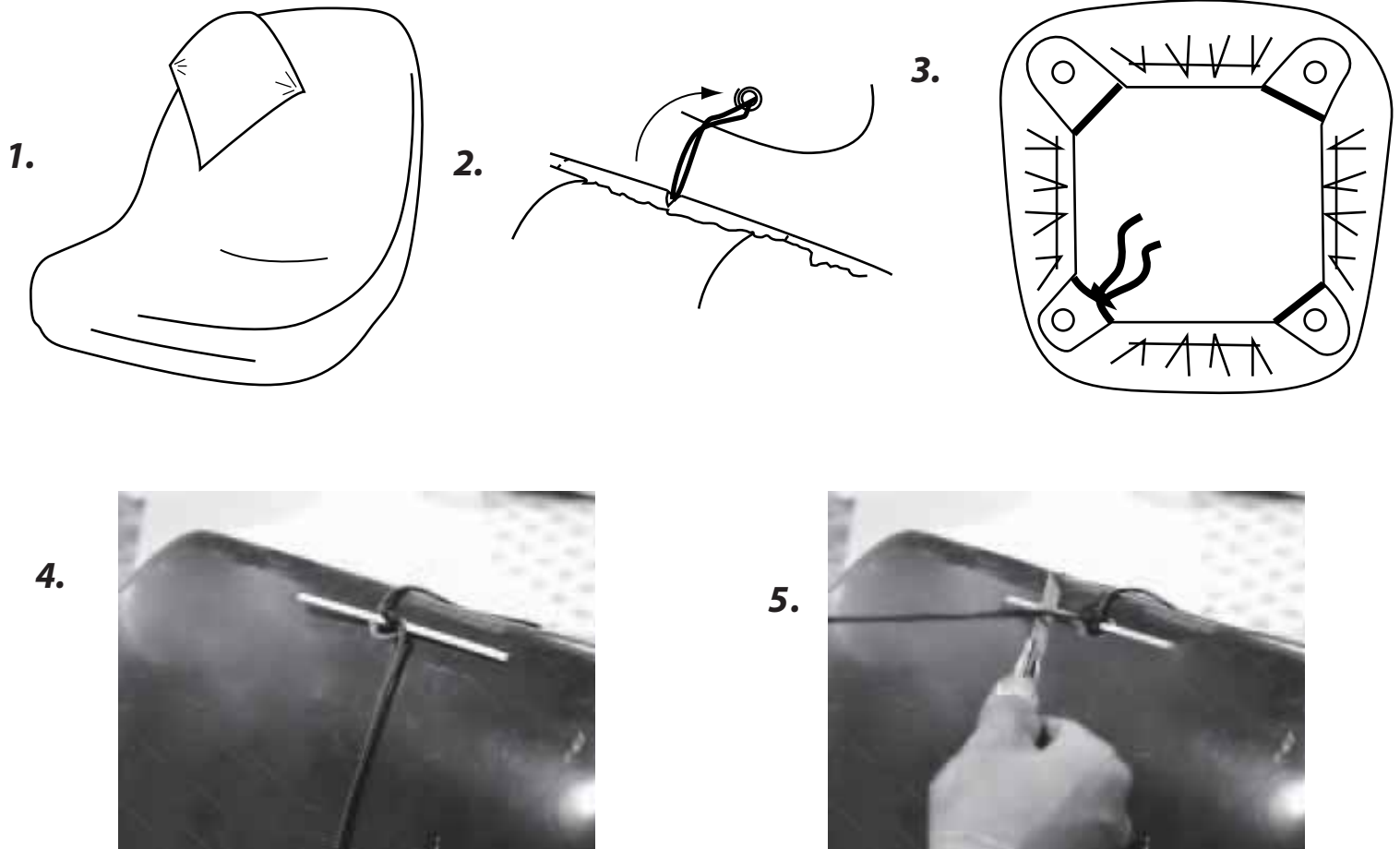

1. Clean seat thoroughly (pic. 1).
2. Place seat cover over backrest and slide down to base.
3. Take Beard Seat Cover and place strings through hole one seat. Make sure OEM Seat Cover is facing correctly on seat (Beard icon should be facing forward on seat)(pic. 2).
4. Turn seat over on its back, undo the loose knot (where the strings were put through), so that the OEM Seat Cover cannot come detached from seat (pic. 2).
5. Wrap cover around base and loosely align folds (pic.3).
6. With the seat still turned on its back, undo the loose knot and use provided wire to pull cover tight against seat and then tying a tight knot in the string. Cut off excess string. (pic. 4-5).
7. Pull drawstring until cover is tight on base (pic.3).