



# Yamaha RHINO

## Gas Cap



### Hardware Included

- N/A

### Tools Required

- *Phillips Screwdriver*

# **Rhino Gas Cap** **Installation Instructions**

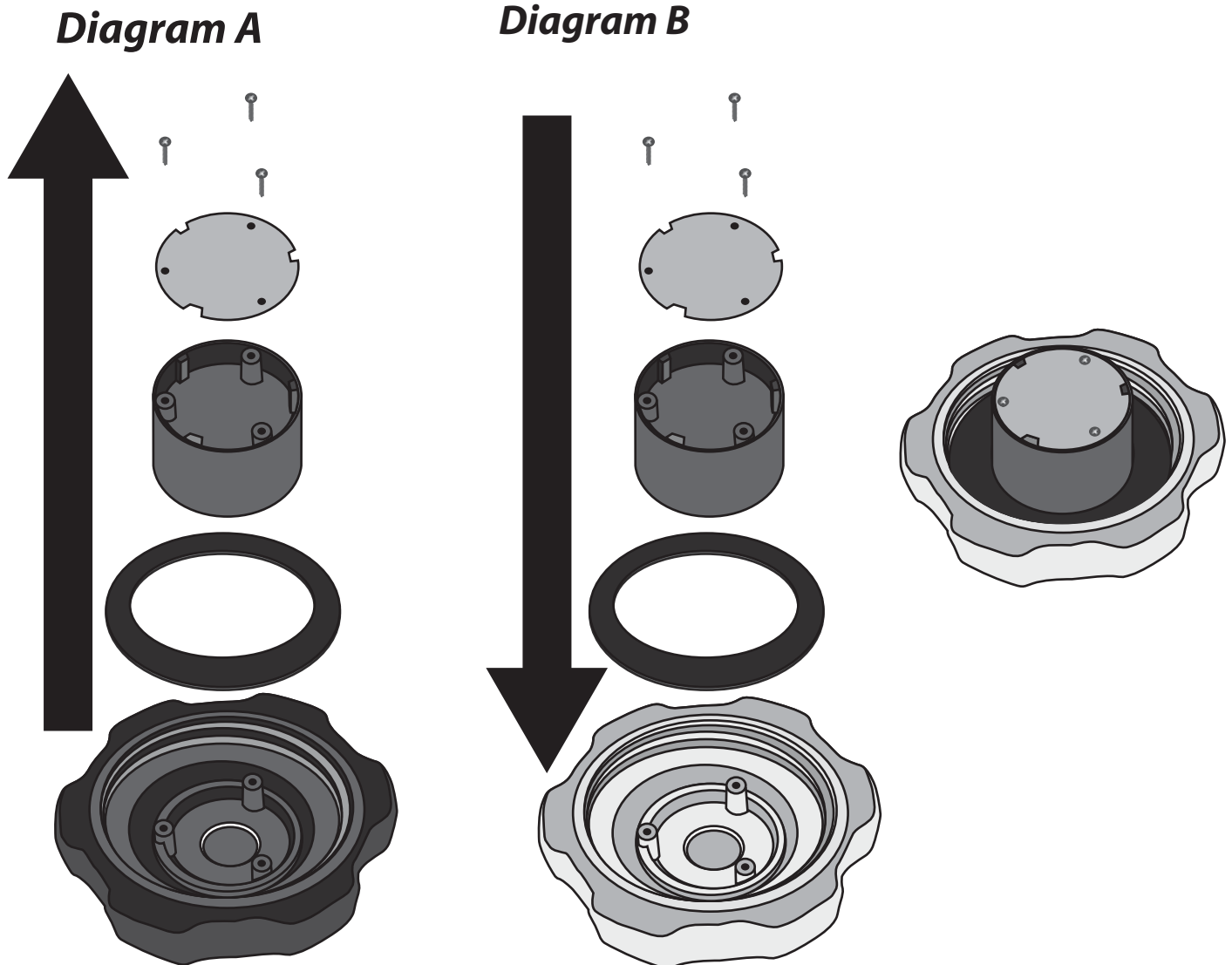

Prior to getting started, we recommend you using gloves and wearing safety glasses for proper protection.

- 1.) Remove 3 screws from inside stock gascap. Save for later use.
- 2.) Remove center assembly and rubber gasket. Save for later use.
- 3.) Replace stock gasket in new gascap housing.
- 4.) Replace stock center assembly in new gascap.
- 5.) Replace stock screws and firmly tighten.
- 6.) Tighten gascap onto vehicle until firmly attached. Apply Speed Ind. sticker to center ring on gascap to assure even alignment.